



Sealed Unit Parts Co., Inc.

2230 Landmark Place • Allenwood, NJ 08720 USA
 Phone: 732-223-6644 • Fax: 732-223-1617
 www.supco.com • info@supco.com

The IG-411 is specifically designed to replace Rheem part number 62-22868, and 62-22441-01.

INSTALLATION DATA

IG-411

HOT SURFACE FURNACE IGNITOR EXACT REPLACEMENT RHEEM 62-22868-82 / 62-22441-01

CAUTION

THIS DEVICE SHOULD BE INSTALLED BY A QUALIFIED TECHNICIAN WITH DUE REGARD FOR SAFETY AS IMPROPER INSTALLATION COULD RESULT IN A HAZARDOUS CONDITION.

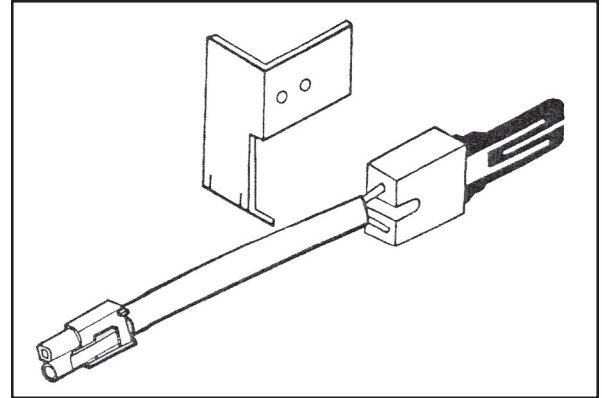

INSTALLATION INSTRUCTIONS

WARNING

Hot surface ignitors get hot! up to 2500°F. Therefore wait several minutes allowing the ignitor to cool down, before attempting any service work. Failure to do so will cause severe personal injury.

CAUTION

Turn off all gas and electrical power to the equipment being serviced. Failure to do so can cause severe injury, death or property damage.

1. Locate model number of the furnace rating plate then find it in the chart below

2. Refer to figure 1 and then 2 or 3 as directed on back page, when installing new ignitor.
3. Remove old ignitor from furnace. Save all mounting hardware.
4. To install new ignitor bracket refer to figure 2 or 3 on back page.
5. Installation is now complete, put system back in service and let it run through two or three start-ups to verify proper operation.

FURNACE MODEL	FIGURE NO.	FURNACE MODEL	FIGURE NO.	FURNACE MODEL	FIGURE NO.
RHEEM/RUDD		HEAT CONTROLLER		CENTER ENVIRONMENTAL SYSTEMS	
GDA	3	GAD	3	P-UXD	3
GDB	3	GAU	3	WEATHERING	
GDD	3	GSD	3	GDW	3
GDE	2	GSU	3	GDWE	3
GEB	3	GYDA	2	GDWHC	3
GKA	3	GYUA	2	GDWHE	2
GLA	3	GZD	3	GHCA	2
GLB	3	GZU	3	GHID	2
GLD	3	NORDYNE		GHST	2
GLE	2	RFYDC	3	GUW	3
GUH	2	RFYDD	2	GUWE	3
GUJ	2	RFYUA	3	GUWHC	3
GVC	2	RFYUC	3	GUWHE	2
GWH	2	RFYUD	2		
GYC	2				

NOTE: On these models listed below, use the existing bracket not the new bracket.
 GDG, GLG, GVG, WGDAG, WGLAG, WGVAG.

Figure #1

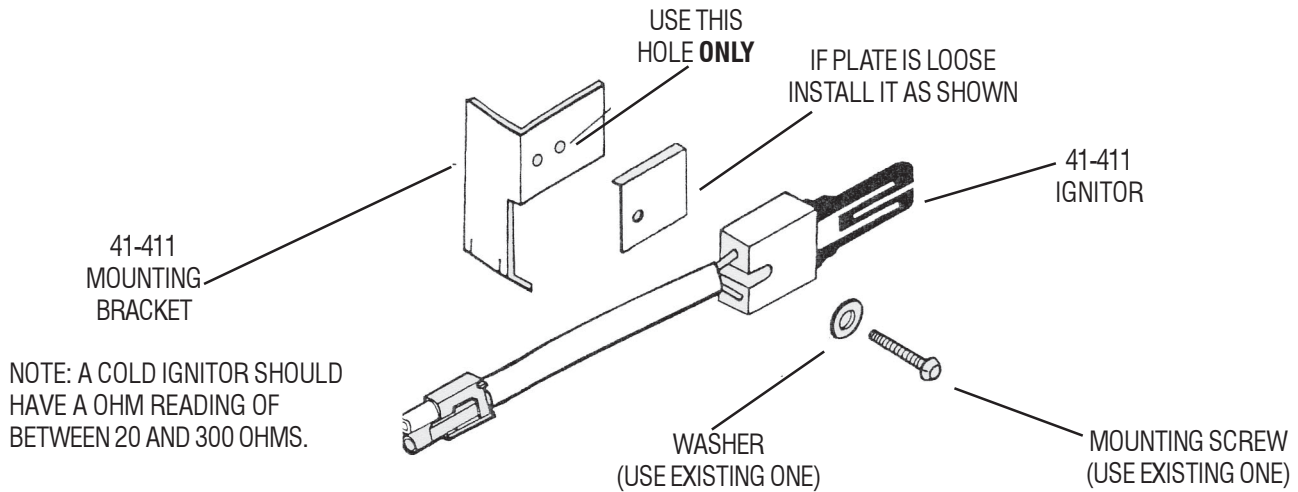

Figure #2

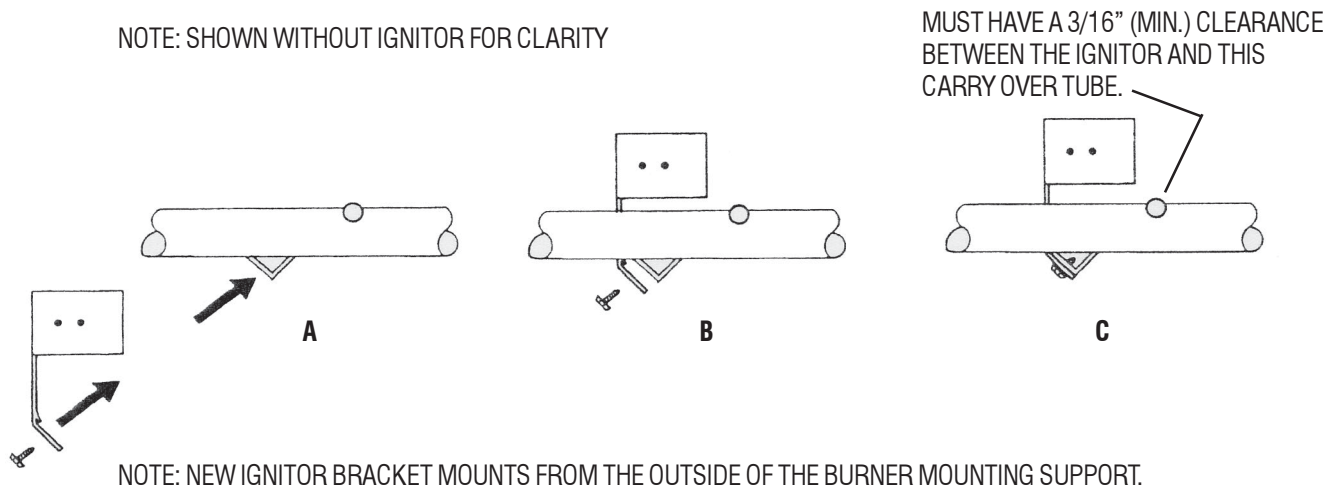

Figure #3

